

CONSTRUCTION D'UNE HALLE LOGISTIQUE ET LOCAUX ADMINISTRATIFS | 1ère réalisation 1623 Semsales (FR)

Our choice of BAT-MANN as general constructor for our logistic centre in Semsales was based on previous recommendations and BAT-MANN's competitive pricing. The fact that all negotiations and discussions, prior to and during the building period, could be done in English also helped in our decision process.

The construction has been carried out according to plan. There have been some flaws but these have all been handled correctly by BAT-MANN.

Lars Enström

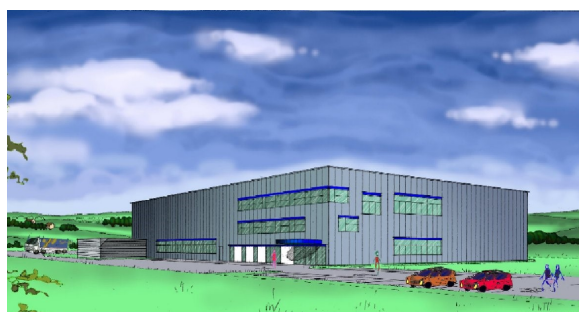

Surface plancher	2'086 m2
Volume SIA	26'000 m2
Durée des travaux	7 mois
Année de réalisation	2006